

CABLE TRAY

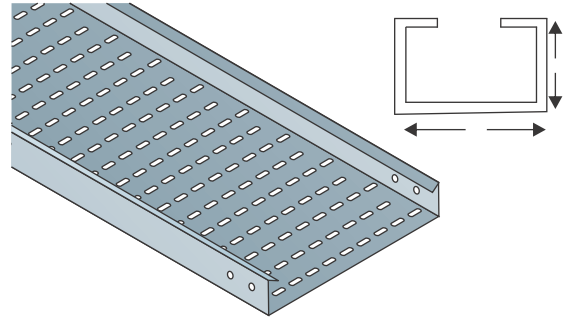
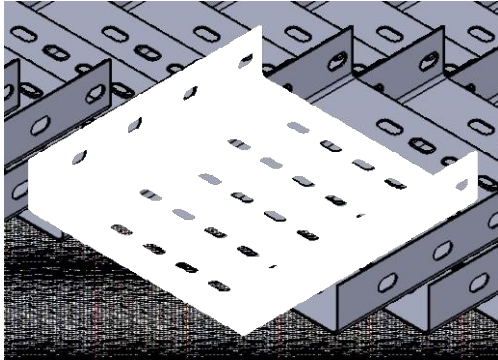

STRAIGHT LENGTH & FITTINGS(mm)		
Range / Width (W)	Thickness (T)	Height (H)
50 - 150	1.0	50/ 75 /100
225 - 300	1.2	50/ 75 /100
450 - 600	1.5	50/ 75 /100
750 - 900	2.0	50/ 75 /100

STANDARD FINISHES :

HDG Hot Dip Galvanized to BSEN ISO 1461:1999 (Formerly BS 729).

PG Pre Galvanized to BSEN 10142 & 10143.

MATERIAL :

Carbon steel & stainless steel

Heavy Duty Return Flange Perforated Cable Trays are made in standard length of 3mtrs. They can be produced different lengths upon request.

ORDER PATTERN (mm)					
FLANGE	ITEM	WIDTH	FINISH	TYPE	THICKNESS
KI- CT	CT	50	FINISH	1 / 2	THK
KI- CT	CT	100	FINISH	1 / 2	THK
KI- CT	CT	150	FINISH	1 / 2	THK
KI- CT	CT	225	FINISH	1 / 2	THK
KI- CT	CT	300	FINISH	1 / 2	THK
KI- CT	CT	450	FINISH	1 / 2	THK
KI- CT	CT	600	FINISH	1 / 2	THK
KI- CT	CT	750	FINISH	1 / 2	THK
KI- CT	CT	900	FINISH	1 / 2	THK